

# Air-Operated Double Diaphragm Pumps

# IWAKI AIR

## 1/4" TC-X051 Series

The TC-X051 is a small compact pump with an exceptional flow rate designed to be installed into liquid transfer applications. Featuring the new Looped C® Air Motor Technology. Multi-port options available.

Maximum Flow Rate: 4.0 GPM (15 LPM)  
 Maximum Discharge Head: 230 FT (70 m)  
 Available in: Stainless Steel, Aluminum, Pure Polypropylene, Acetal (POM),  
 Glass Fiber Reinforced Polypropylene (GFRPP), & PVDF (Kynar®)  
 Spool valve type: Looped C-Spring Valve  
 Certification: CE, ATEX (select models)

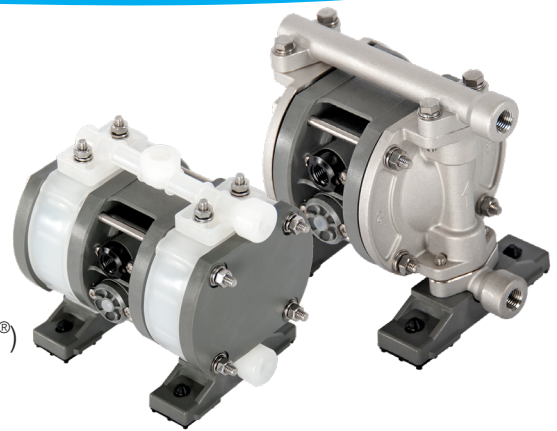

### SPECIFICATIONS

| Material Code*                         | AT                       | ST      | PT       | VT      | DT      | GT |
|--|--------------------------|---------|----------|---------|---------|----|
| Max Flow Rate                          | 4.0 GPM (15 LPM)         |         |          |         |         |    |
| Max Air Pressure                       | 100 PSI (0.7 MPa)        |         |          |         |         |    |
| Max Air Consumption                    | 8.83 scfm (250 L/min)    |         |          |         |         |    |
| Supply Air Pressure Range <sup>1</sup> | 30-100 PSI (0.2-0.7 MPa) |         |          |         |         |    |
| Liquid Discharge Volume per cycle      | 0.7 oz (20 mL)           |         |          |         |         |    |
| Connection Suction x Discharge         | NPT 1/4"                 |         |          |         |         |    |
| Weight                                 | 3.53 lbs                 | 6.0 lbs | 2.87 lbs | 3.7 lbs | 3.1 lbs |    |
|  | 1.6 kg                   | 2.7 kg  | 1.3 kg   | 1.7 kg  | 1.4 kg  |    |

\* See Chart and Model Number nomenclature on back page for materials

Note 1: A supply air pressure of 30 PSI (0.2 MPa) or more is required to operate the pump. If the supply pressure is less than 30PSI (0.2 MPa), the pump may not operate properly.

Pump Liquid Temperature Range: AT, ST, VT 32-212°F (0-100°C) PT, VT, DT 32-180°F(0-82°C)

Ambient Temperature Range: 32-158°F (0-70°C)

Not recommended for use with slurry liquid.

Viscosity Limit: ~100 cps (0.1 Pa-s) (Please contact your distributor for more details)

### PERFORMANCE CURVES

#### TC-X051"X"T

— Flow  
 - - - Air

Conditions:  
 4" (10 cm) flooded suction.  
 Ambient temperature: 79°F (26°C)  
 Liquid temperature: 73-77°F (23-25°C)

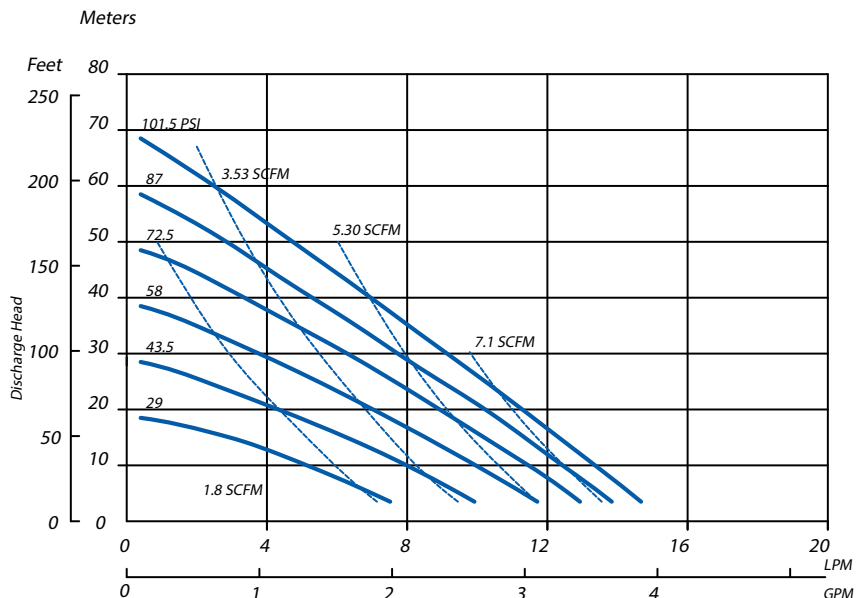

## WET END MATERIALS

| Model    | Part Name             | AT       | ST      | GT              | VT               | DT                 | PT                    |
|----------|-----------------------|----------|---------|-----------------|------------------|--------------------|-----------------------|
| TC-X 051 | Pump Wetted Parts     | AL Alloy | Cast SS | PPG             | PVDF             | Acetal             | Pure Poly             |
|          | Diaphragm             | PTFE     | PTFE    | PTFE            | PTFE             | PTFE               | PTFE                  |
|          | Flat Valve            | PTFE     | PTFE    | PTFE            | PTFE             | PTFE               | PTFE                  |
|          | Valve Seat            | SS316    | SS316   | PPG             | PVDF             | Acetal             | Pure Poly             |
|          | Outer Diaphragm Plate | AL       | SS316   | PPG<br>(SS303*) | PVDF<br>(SS304*) | Acetal<br>(SS304*) | Pure Poly<br>(SS303*) |
|          | Center Body           | Ryton®   |         |                 |                  |                    |                       |

AL Alloy  
AL  
Acetal  
SS316

Aluminum Alloy (ADC12/AC4C)  
Aluminum (A5056)  
Polyoxymethylene (POM)  
Stainless Steel Grade 316

GFRPP  
PTFE  
PVDF  
Cast SS  
Pure Poly

Glass Fiber Reinforced Polypropylene  
Polytetrafluoroethylene (Teflon®)  
Polyvinylidene Fluoride (Kynar®)  
Cast Stainless Steel (SCS14)  
Pure Polypropylene (PP)

\*SS303  
\*SS304  
Ryton®

Stainless Steel Grade 303 (Insert material)  
Stainless Steel Grade 304 (Insert material)  
Polyphenylene Sulphide (PPS)

## DIMENSIONS

TC-X051 AT/ST

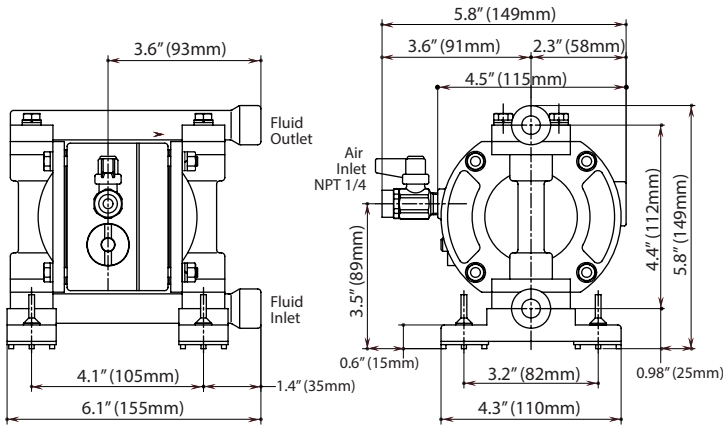

TC-X051 GT/VT/DT/PT (max dimensions shown)

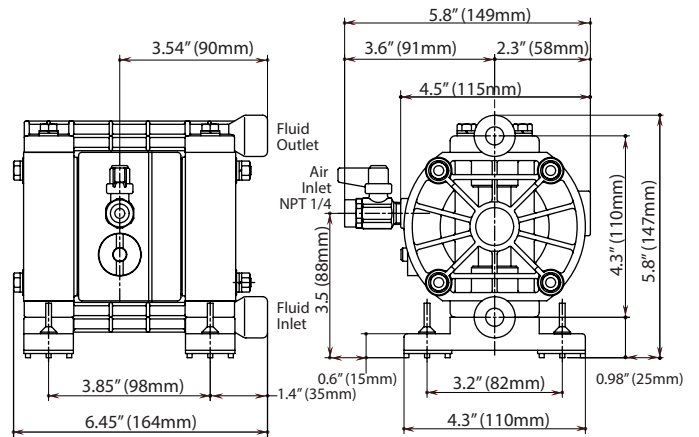

## MODEL NUMBER

